

REVISIONS

| NO. | DESCRIPTION | DATE / SIGN |
|-----|-------------|-------------|
|     |             |             |
|     |             |             |

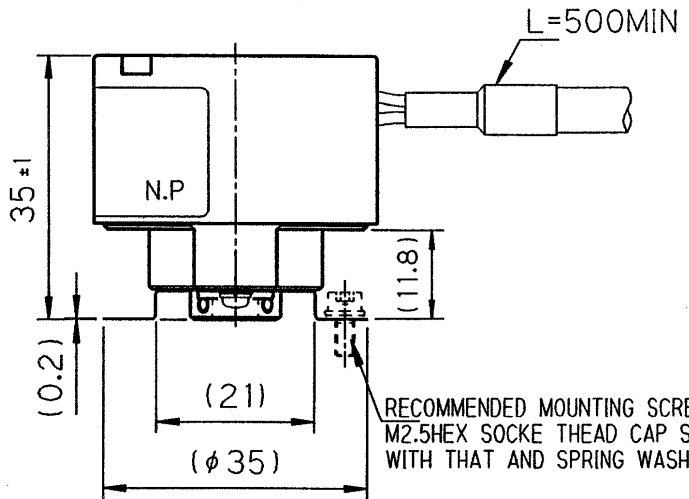

RECOMMENDED MOUNTING SCREWS:  
M2.5HEX SOCKET HEAD CAP SCREWS  
WITH THAT AND SPRING WASHERS

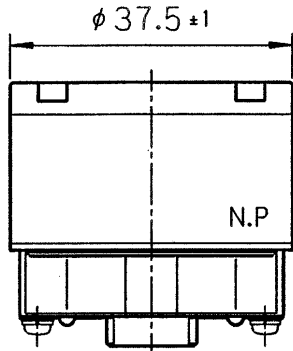
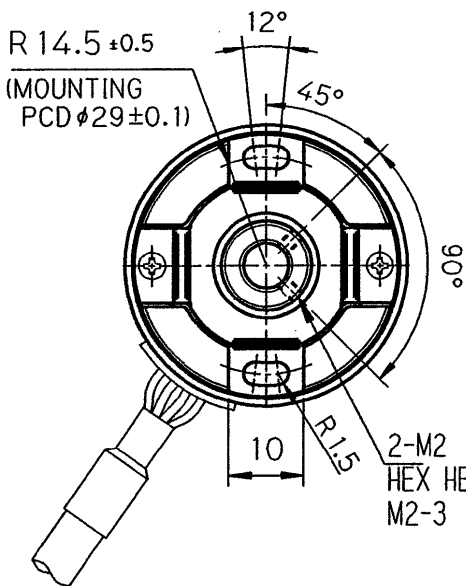

2-M2  
HEX HEAD SET SCREWS  
M2-3

ENCODER MOUNTING SURFACE

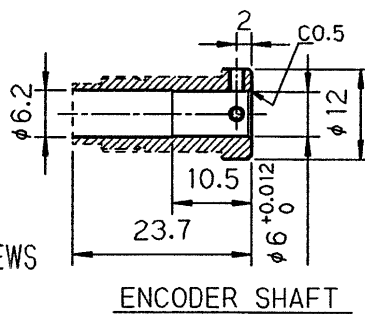

ENCODER SHAFT

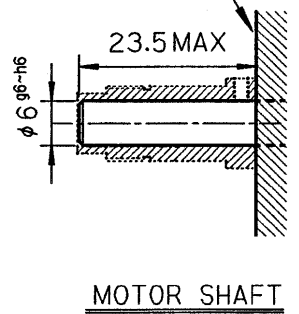

MOTOR SHAFT

NOTES

1. Z IS GENERATED WHEN HUB IS ORIENTED AS SHOWN ABOVE.
2. SHAFT LENGTH 23.5mm MAX. FROM MOUNTING SURFACE.
3. PULLING THE CABLE CAUSES DISCONNECTION OF LEADS FROM THE ENCODER.
4. PLEASE USE A BALL POINT WRENCH OR HEX KEY WRENCH(FIG.1) TO TIGHTEN THE MOUNTING SCREW.
5. DIMENSIONS TOLERANCE :±0.5mm (UNLESS OTHERWISE SPECIFIED)

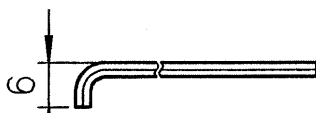

FIG.1 HEX KEY WRENCH

|                            |                  |                      |   |   |   |   |                              |   |    |    |    |       |  |
|----------------------------|------------------|----------------------|---|---|---|---|------------------------------|---|----|----|----|-------|--|
| DS'D<br><i>S. Nakajima</i> | DATE<br>95.12.26 | MODEL NO.            |   |   |   |   | TITLE<br>FA-CODER<br>OUTLINE |   |    |    |    |       |  |
| CH'D<br><i>K. Motoyama</i> | SCALE<br>1/1     | 3RD ANGLE PROJECTION |   |   |   |   | 8                            | 9 | 10 | 11 | 12 | SHEET |  |
| APP'D<br><i>M. Saito</i>   | DWG NO.          | 3                    | 4 | 5 | 6 | 7 | 8                            | 9 | 10 | 11 | 12 | SHEET |  |
|                            | 052145000F       | 4                    | 0 | 0 | 0 | 0 | 0                            | 0 | 0  | 0  | 0  | 40 /  |  |

JDE 18  
JIS A4(210X297)